

HS4000 Conversion Installation Guide

Remove Old Valve

1.) Loosen Screw on Hose Clamp,
Above Locking Mechanism

2.) Remove Old Valve

- Pull from opposite end of locking mechanism.
- Disconnect low voltage wires.

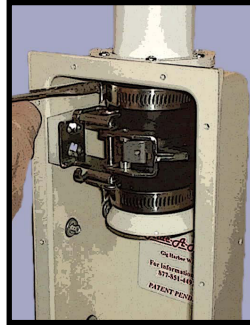

Install Rough-In Kit

1.) Score and Cut Off Both
Mounting Tabs

Before

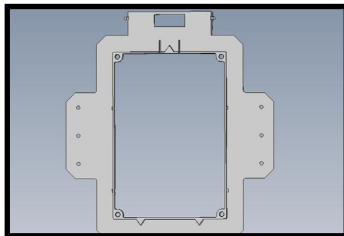

After

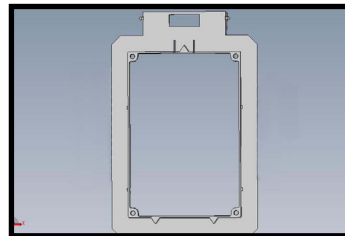

2.) Using PVC Pipe Glue, Glue the
Pipe Fitting onto Existing Pipe
- Make sure the pipe seats all the
way to the ridge inside the pipe
fitting.

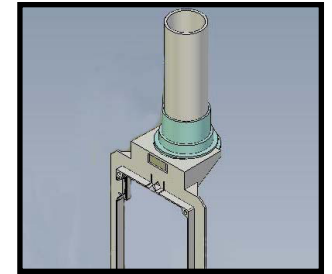

3.) Install Rough-In Frame

- Slide the rough-in frame into
the groove of the pipe fitting.
- Rough-In frame will be
hanging from pipe fitting in
opening.

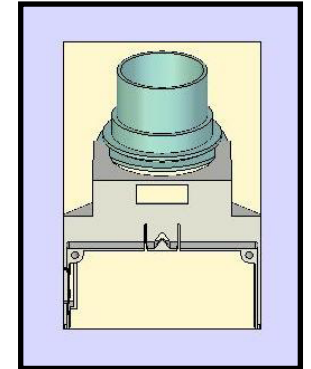

4.) Insert Finish Nails

- You may want to insert small
finish nails through the holes
in the rough-in frame going
into the edge of the sheetrock.
This will help hold the frame
in place when installing the
valve.

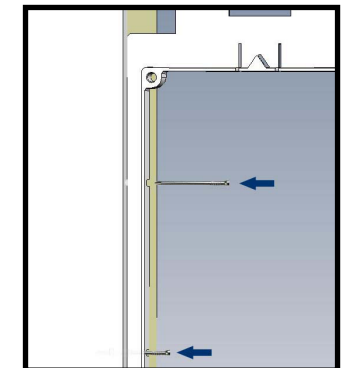

Install Conversion Plate

1.) Insert Conversion Plate Into the Hole

Before

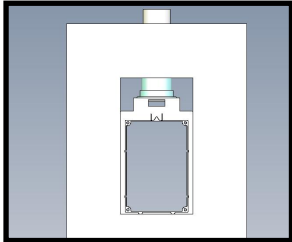

After

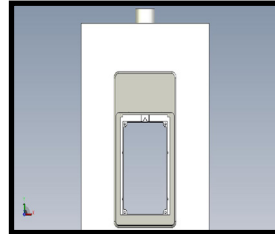

2.) (If Needed)

- Sheetrock hole can be cut and expanded up to 3/4 inches.

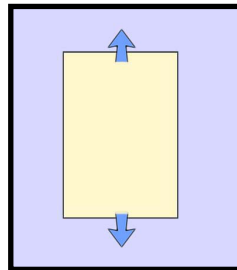

Install New Valve

1.) Apply a Lubricant to the O-ring

2.) Reconnect low voltage wires.

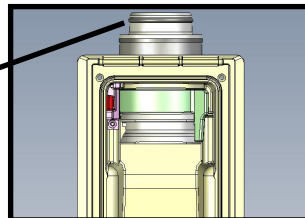

3.) Insert Valve in the Rough-In Frame

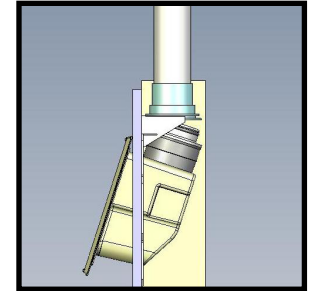

4.) Secure Valve

- Align four holes in valve assembly with the holes in frame.
- Secure with four screws, begin threading the screws by hand.

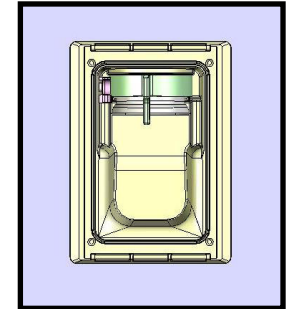

5.) Install the Door

- Line up the door and valve and press it into place.

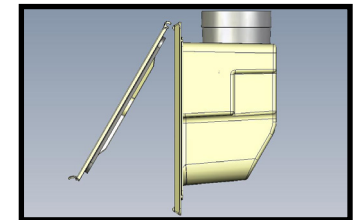

Finished HS4000 Conversion Installation

